



HUISSERIES / CADRES

MÉTAL

MODÈLES

PORTE BATTANTE

Acier thermolaqué
Inox (E10)
Acier thermolaqué résistant à la corrosion (Classe environnementale C5)

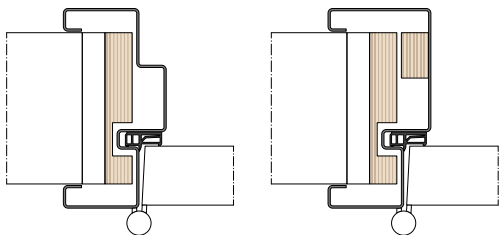

Variante bloc

PORTE VA-ET-VIENT

Acier thermolaqué
Inox
Acier thermolaqué résistant à la corrosion (Classe environnementale C5)

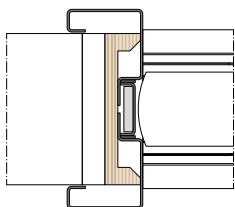

PORTE COULISSANTE

Acier thermolaqué
Inox (E10 + E11 30)
Acier thermolaqué résistant à la corrosion (Classe environnementale C5)

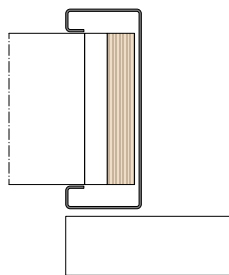

CHÂSSIS FIXE

Acier thermolaqué
Inox (E10)
Acier thermolaqué résistant à la corrosion (Classe environnementale C5)

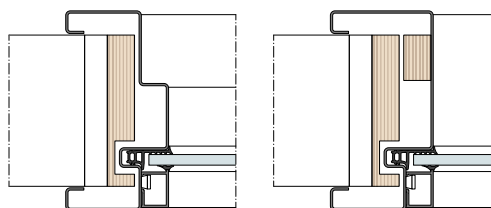

Variante bloc

CHAMBRANLES

ASSEMBLAGE D'ANGLE

Type T (Standard)

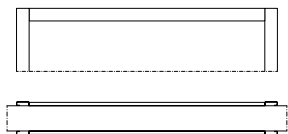

Type V

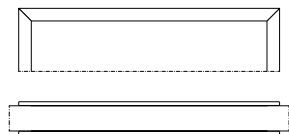

OPTIONS

Joint creux

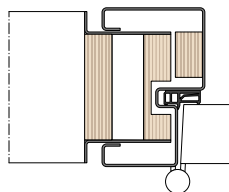

Asymétrie

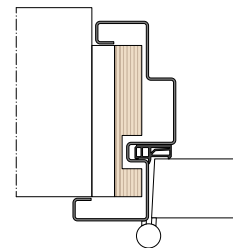

BOIS

MODÈLES

PORTE BATTANTE

Multiplex

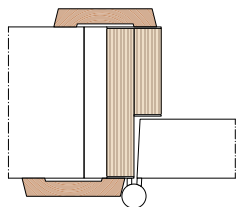
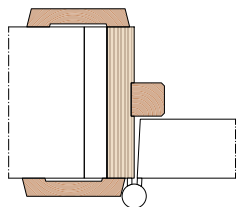

Variante bloc

MDF

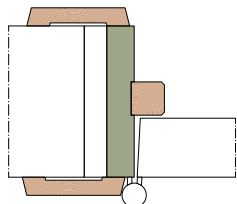

Massif

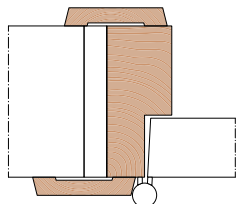

Rubberwood (E10)

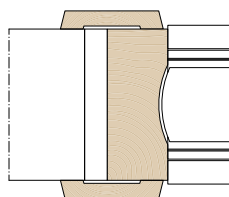

PORTE COULISSANTE

Multiplex (E10 + E11 30)

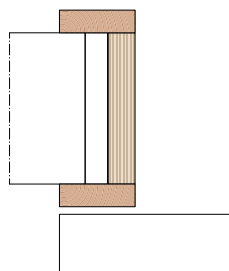

Rubberwood

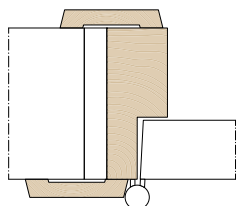

CHÂSSIS FIXE

Multiplex (E10)

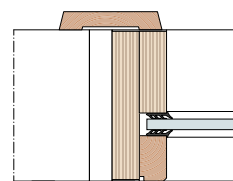
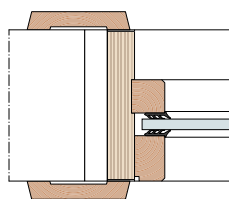

Variante bloc

PORTE VA-ET-VIENT

Multiplex

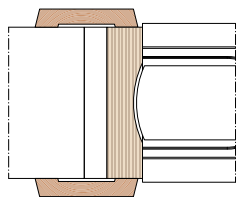

Massif

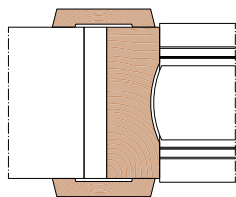

Massif

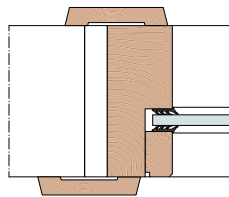

Rubberwood

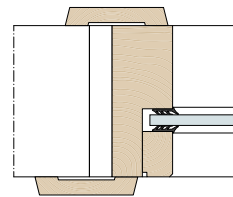

CHAMBRANLES

ASSEMBLAGE D'ANGLE

Type V (Standard)

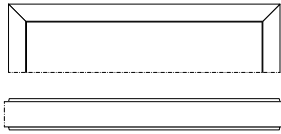

Type G

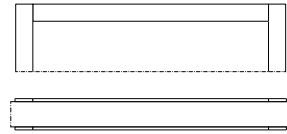

TYPE

Trapèze



Droit



OPTIONS

Joint creux

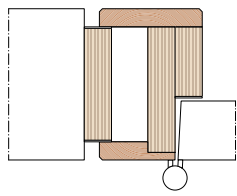

Asymétrie

